

TREE PLANTING KEYS

<b>Qp</b>	QUERCUS FULVASTRIS (Oak)
<b>Ps</b>	POPULUS SPINOSA (Poplar)
<b>Ol</b>	OLEA EUROPAEA SIBIRICA (Olive)
<b>Rl</b>	RHUS LANCEATA (Sumac)
<b>Sg</b>	STYRACIA GUINENSE (Liquidambar)
<b>F</b>	FRAXINUS (Ash)
<b>Ls</b>	LIQUIDAMBAR STRACONFLUA (Liquidambar)
<b>Cs</b>	CELTIS SENEGALENSIS (Hackberry)
<b>Qc</b>	QUERCUS CERRIS (Oak)
<b>Pa</b>	PLATANUS X ACERIFOLIA (London Plane)

- NOTES:
1. STREET TREE PLANTING DISTANCES ARE ONLY INDICATIVES PER STREET TREE PLAN.
  2. DISTANCES BETWEEN TREES SHOULD BE EQUAL AS FAR AS POSSIBLE WITHIN EACH STREET.
  3. OPTIMAL DISTANCES BETWEEN STREET TREES SHOULD BE BETWEEN 6.5 METERS AND 8 METERS, CENTRE TO CENTRE.
  4. DISTANCES MAY NOT EXCEED 10 METERS, CENTRE TO CENTRE.

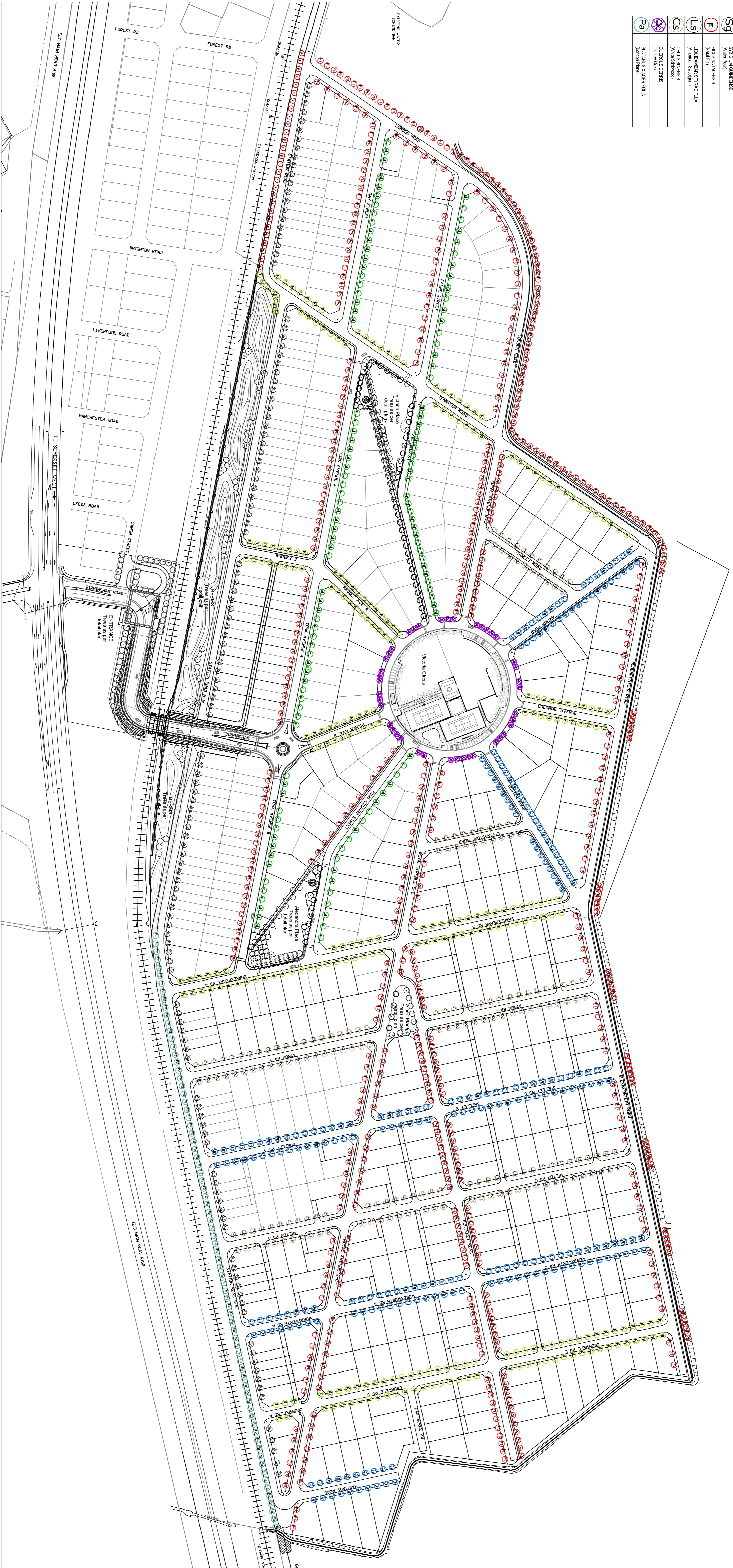

THE DETAIL & AND DESIGN SHOWN ON THIS DRAWING ARE COPYRIGHT AND REMAIN THE PROPERTY OF O/P ASSOCIATES

Key Plan  
 1. TREE PLANTING KEYS  
 2. STREET TREE PLANTING KEYS  
 3. LANDSCAPE ARCHITECTURE  
 4. CIVIL ENGINEERING  
 5. STRUCTURAL ENGINEERING  
 6. MECHANICAL ENGINEERING  
 7. ELECTRICAL ENGINEERING  
 8. PLUMBING ENGINEERING  
 9. SANITARY ENGINEERING  
 10. FIRE ENGINEERING  
 11. ENVIRONMENTAL ENGINEERING  
 12. TRAFFIC ENGINEERING  
 13. SOIL MECHANICS  
 14. GEOTECHNICAL ENGINEERING  
 15. LANDSCAPE ARCHITECTURE  
 16. CIVIL ENGINEERING  
 17. STRUCTURAL ENGINEERING  
 18. MECHANICAL ENGINEERING  
 19. ELECTRICAL ENGINEERING  
 20. PLUMBING ENGINEERING  
 21. SANITARY ENGINEERING  
 22. FIRE ENGINEERING  
 23. ENVIRONMENTAL ENGINEERING  
 24. TRAFFIC ENGINEERING  
 25. SOIL MECHANICS  
 26. GEOTECHNICAL ENGINEERING

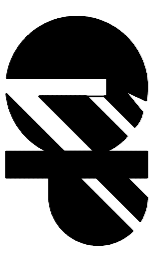

**O/P Landscape Architects**  
 11, GARDNER STREET, DUBLIN 1, IRELAND  
 Telephone: +353 1 462 1322 Fax: +353 1 462 1323  
 Email: info@op.ie Website: www.op.ie

Document Control Status

FOR INFORMATION

**KELDERHOF**  
**RESIDENTIAL DEVELOPMENT**  
**STREET TREE PLANTING PLAN**  
 Date: 192 / 01TP / 001  
 Scale: 1:1000 (DL A0)  
 Date: SEPTEMBER 2011  
 Model No.: A